

DETONATOR Marui M1911 Conversion Kit Installation Manual

*You may find more quantity of parts than necessary.
Those are the extra.

Hop Up Chamber

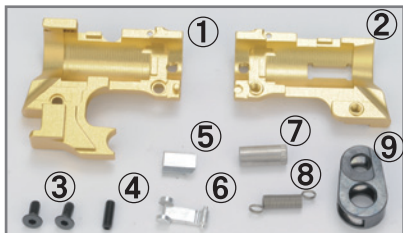

- ① Hop Up Chamber (Left)
- ② Hop Up Chamber (Right)
- ③ Hex Screw M2x4 *2pcs
- ④ Set Screw M2x6
- ⑤ Hop Up Adjust Lever (Rear)
- ⑥ Hop Up Adjust Lever (Front)
- ⑦ Barrel Link Pin
- ⑧ Short Recoil Assist Spring
- ⑨ Barrel Link

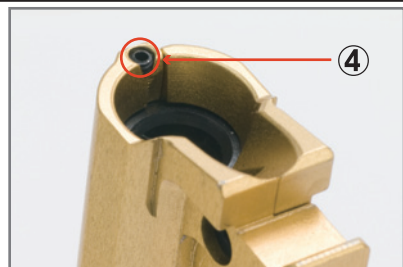

Install ④ into red circle. Screw it and more hop up, unscrew it and less hop up.

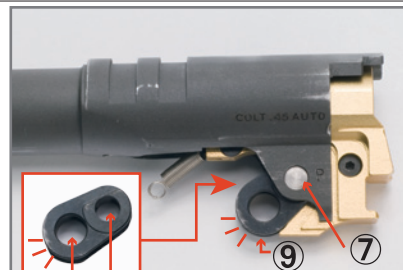

Insert inner barrel into outer barrel.
Fix ⑨ to outer barrel by ⑦ into small hole.

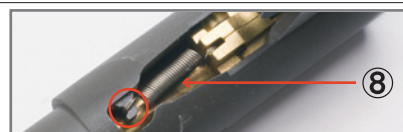

Hook ⑧ into red circle.

Blowback Housing

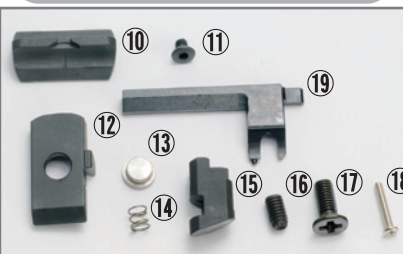

- ⑩ Rear Sight ⑪ Hex Screw M2x1.5
- ⑫ Firing Pin Plate
- ⑬ Dummy Firing Pin
- ⑭ Dummy Firing Pin Spring
- ⑮ Dummy Extractor
- ⑯ Set Screw M3x5
- ⑰ Cross-head Screw M3x6
- ⑱ Cross-head Screw M1.3x7.5
- ⑲ Slide Release Notch Enhanced Part



Hook ⑧ on red circle.

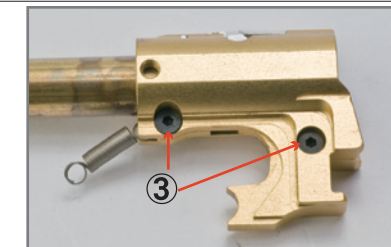

Screw ① and ② by ③.



After installing rear sight ⑩, fix it by ⑪.

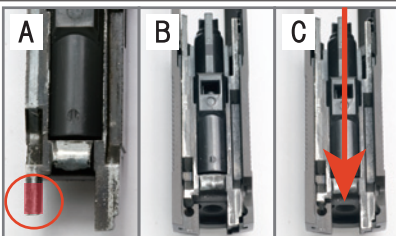

Cut off red part in A by handsaw.
Put blowback housing into slide (B), then push it backward.

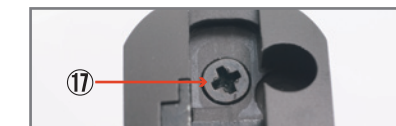

Fix blowback housing by ⑰.

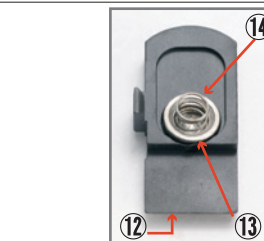

Put ⑬ and ⑭ on ⑫.
(It is easier to use glue to fix ⑬ on ⑭.)

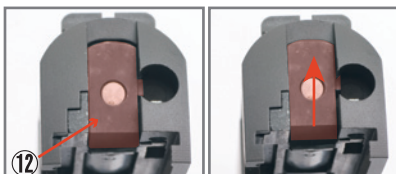

Install ⑫ into slide (left photo),
push it upward (right photo).

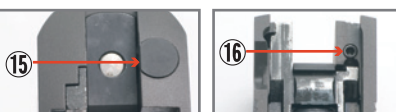

Insert ⑮ into slide (left photo),
fix it by ⑯ (right photo).

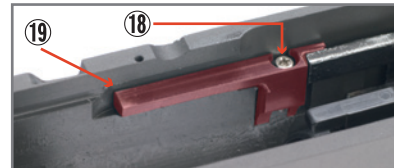

Insert ⑲ into slide and screw by ⑱.

Slide Release Plate

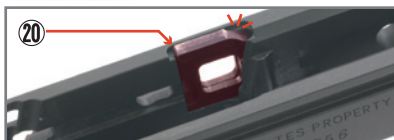

Insert ⑳ into slide.
*Install plunger tube
after installing slide release plate.

Barrel Stopper

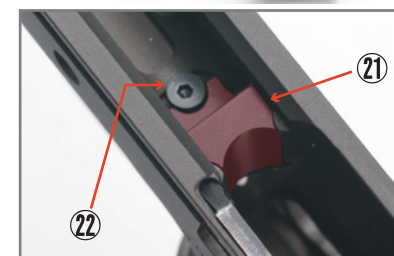

Install ⑳ as the photo, fix it by ㉑.

Recoil Buffer



- ㉑ Recoil Buffer
- ㉒ O-ring 1x7
- ㉓ O-ring 1.5x7.5



*This part is used for adjusting short stroke.
It is not necessary to install it.

Install ㉑, ㉒ and ㉓ in order.

Inner Chasis



- ㉑ Inner Chasis (Left)
- ㉒ Inner Chasis (Right)
- ㉓ Knocker Lock Spacer
- ㉔ Screw M2x4.5



Install hammer, sear and knocker in ㉑.



Screw inner chasis ㉑ and ㉒ by ㉔.
(It is advisory to use glue not to loose it.)
If screw ㉔ is loosen,
it may break magazine and this screw.

Knocker Lock

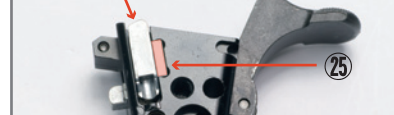

After installation knocker lock,
insert ㉓ as the photo shown.
Then put knocker spring.